



the
ACCOMMODATION
BUREAU



Property Description

3 Bedroom End Of Terrace House With Parking.

This traditional style three bedroom end of terrace house is located close to Bodmin Hospital and the town centre, with allocated parking, a garden and accommodation arranged over three floors.

Externally, the property has a small front garden accessed via steps and a larger enclosed rear garden with patio, gravelled areas and a seating space. A rear gate provides access to two allocated parking spaces. The property is conveniently positioned for Bodmin Hospital, Primary School and the town centre.

The property is entered via a back porch/utility area, leading into the kitchen fitted with a range-style electric cooker and dishwasher. From the kitchen, the layout continues through to the living room with an ornamental fireplace, and a front porch providing access to the front garden.

On the first floor is the bathroom with a mains-fed shower over the bath, two bedrooms and a study. The landing benefits from built-in storage cupboards. The main bedroom occupies the second floor and includes storage within the eaves. The property has gas central heating throughout.

Energy Rating C (73). Council Tax Band A. Deposit £1,210. Sorry, no smokers, pets or sharers.

Floorplan

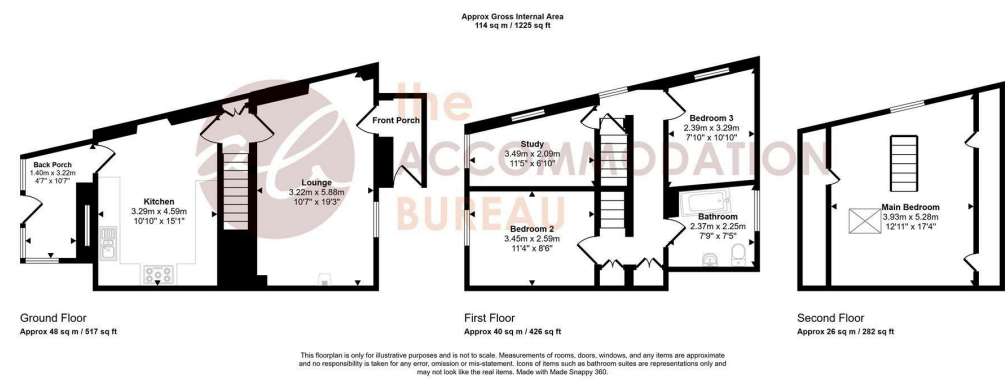

Location

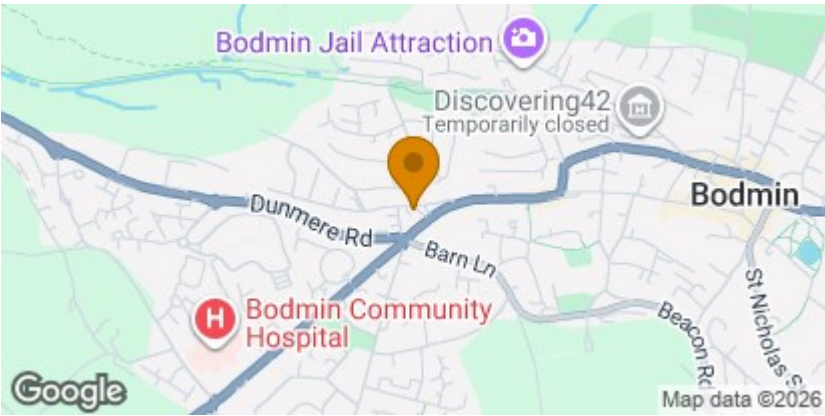

Features

- Two Allocated Parking Spaces
- Range Cooker
- Gas Central Heating
- Close To Bodmin Hospital
- Energy Rating C
- Council Tax Band A
- Study
- 3-Storey House

Letting Information

- Rent: £1,050 Per Calendar Month
- Holding Deposit: £100
- Total Deposit Required: £1,210
- Local Authority: Cornwall Council
- Council Tax Band: A
- Furnishing: Unfurnished
- Available From: 30th January 2026

Energy Efficiency Rating

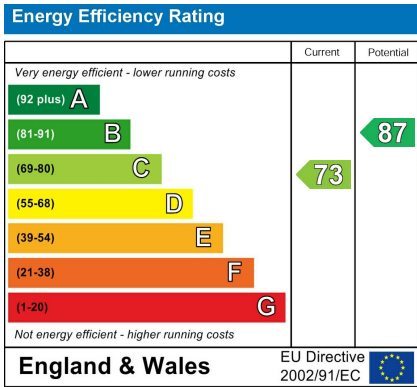

For further information, please call The Accommodation Bureau on 01208 78480.
7 Turf Street, Bodmin, PL31 2DJ. bodmin@theaccommodationbureau.com.

These particulars, whilst believed to be accurate are set out as a general outline only for guidance and do not constitute any part of an offer or contract. Prospective tenants should not rely on them as statements of representation of fact, but must satisfy themselves by inspection or otherwise as to their accuracy. No person in this firms employment has the authority to make or give any representation or warranty in respect of the property.

